

## KENT KHFD160/102 – Hinged Floor Drain

The Kent Stainless Hinged Floor Drain is a hinged variation of our 3 part floor drain. It has been developed specifically for the Middle East residential market. It is ideal for use in Apartment complexes, villa compounds, ablution and public washroom areas. It is manufactured in **Grade 316L stainless steel** with a satin finish as standard, with a mirror polished finish also available. The floor drains have a 102mm diameter outlet as standard.

### Features

- Grade 316 Stainless steel
- 102mm diameter
- Hinged top
- Satin finish as standard; mirror polish finish also available
- Minimum order quantity 200+ pieces

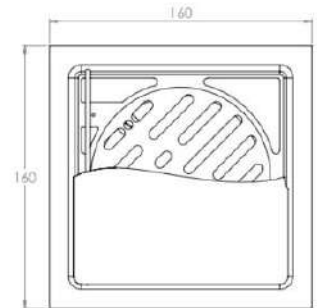
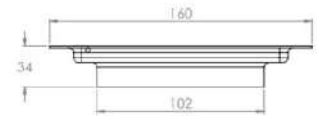

Product Code	Height	Width	Depth	Outlet	Flow Rate*
KHFD160/102	35mm	160mm	160mm	102mm	1.4 l/s

Specify: Kent Hinged Floor Drain KHFD160/102; 160 x 160mm, Grade 316L stainless steel; satin polished finish.



BS EN1253 Class K3